

JSWM SELF-PRIMING CENTRIFUGAL PUMP

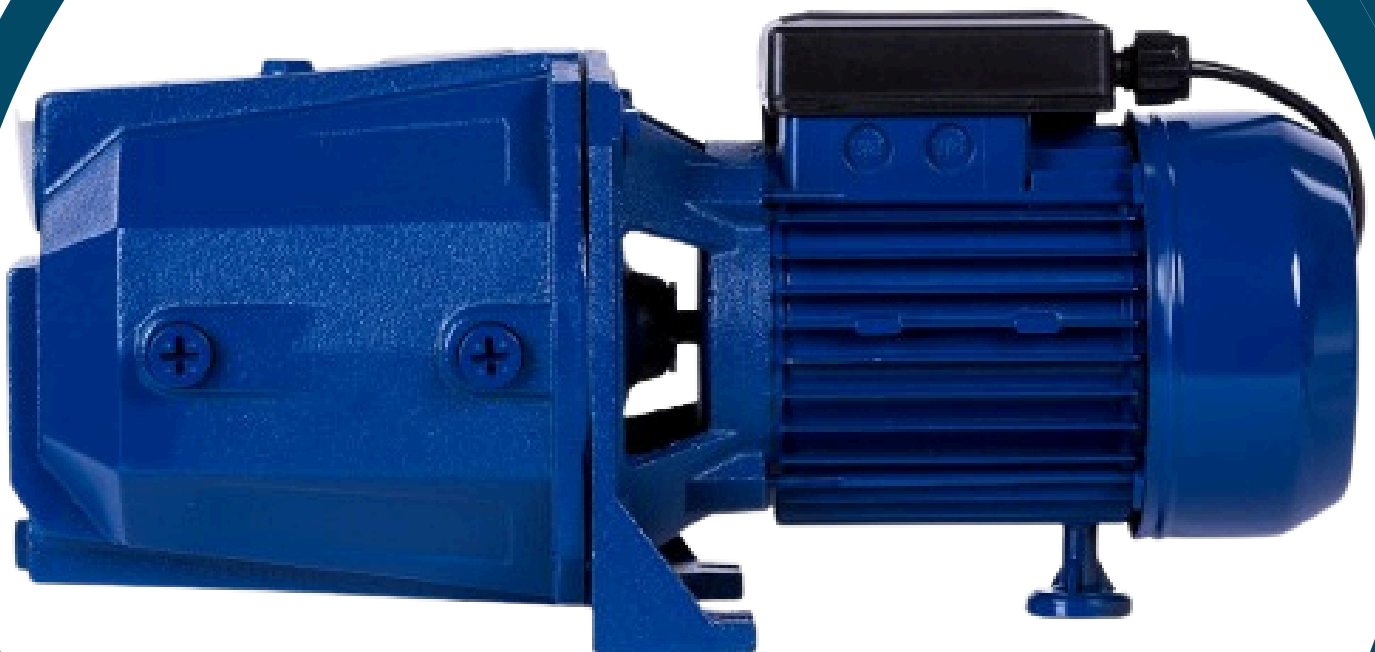

The
WATER & SOLAR COMPANY
WATER & ENERGY SYSTEMS



PRODUCT CATALOGUE

JSWM

Range of Performance

Flow rate:	Max 80 L/min (4.8m³/h)
Head:	Max 52m

Limits of Use

Suction lift:	Max 9m
Liquid temperature:	40oC
Ambient temperature:	40oC

Uses and Installations

The recommended use of this range is for pumping clean water without abrasive particles and non-aggressive liquids towards the pump materials. These pumps are known for their reliability, user-friendly design, and cost-effectiveness, making them ideal for household tasks, irrigation needs, and especially for drawing water from well points. Ensure the pump is installed under a ventilated cover and shielded from rain or water spray.

Construction Characteristics

Pump Body:	Cast Iron
Impeller:	Brass
Motor Shaft:	Stainless Steel 304
Mechanical Seal:	Ceramic-graphite
Electric Motor:	Single-phase 230V - 50Hz with capacitor and thermal overload protector.
Insulation:	Class B
Protection:	IP 44

Diagram

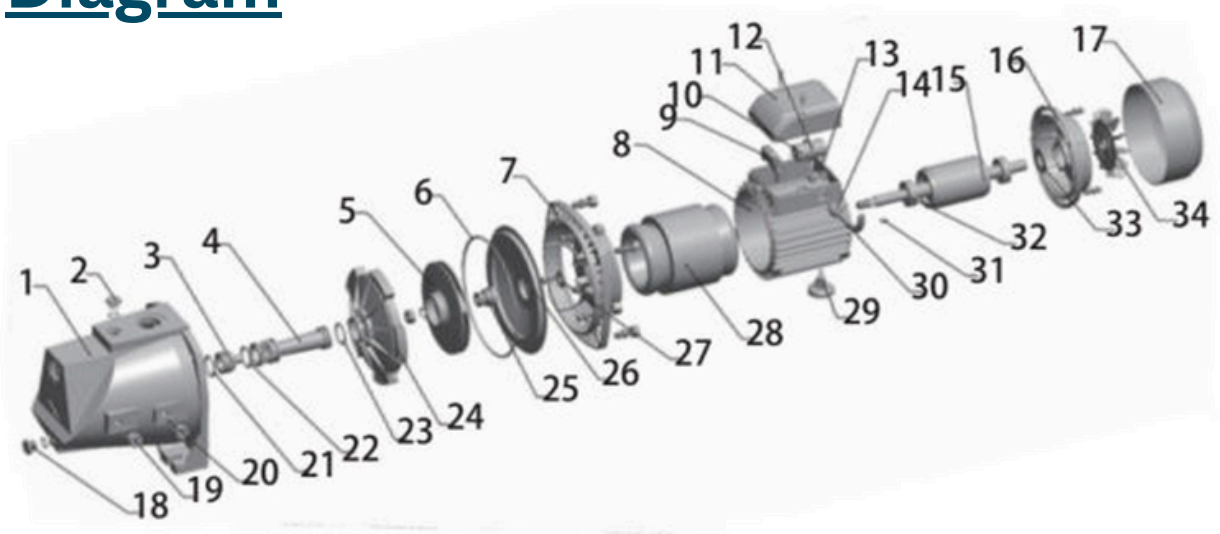

No.	Description	No.	Description	No.	Description	No.	Description
1	Pump body	10	Capacitor	19	Air vent screw	28	Stator
2	Air vent screw	11	Capacitor cover	20	O-Ring	29	Foot
3	Nozzle	12	O-Ring	21	O-Ring	30	Cable
4	Injection pipe	13	Cable fixer	22	O-Ring	31	Key
5	Impeller	14	Cable protector	23	O-Ring	32	Bearing
6	O-Ring	15	Rotor	24	Guide vane	33	Wave Spring
7	Coupling	16	End Cover	25	Mechanical Seal	34	Fan
8	Motor bracket	17	Fan Cover	26	Pump cover		
9	Terminal board	18	Water vent screw	27	Water proof ring		

Hydraulic Performance Curve

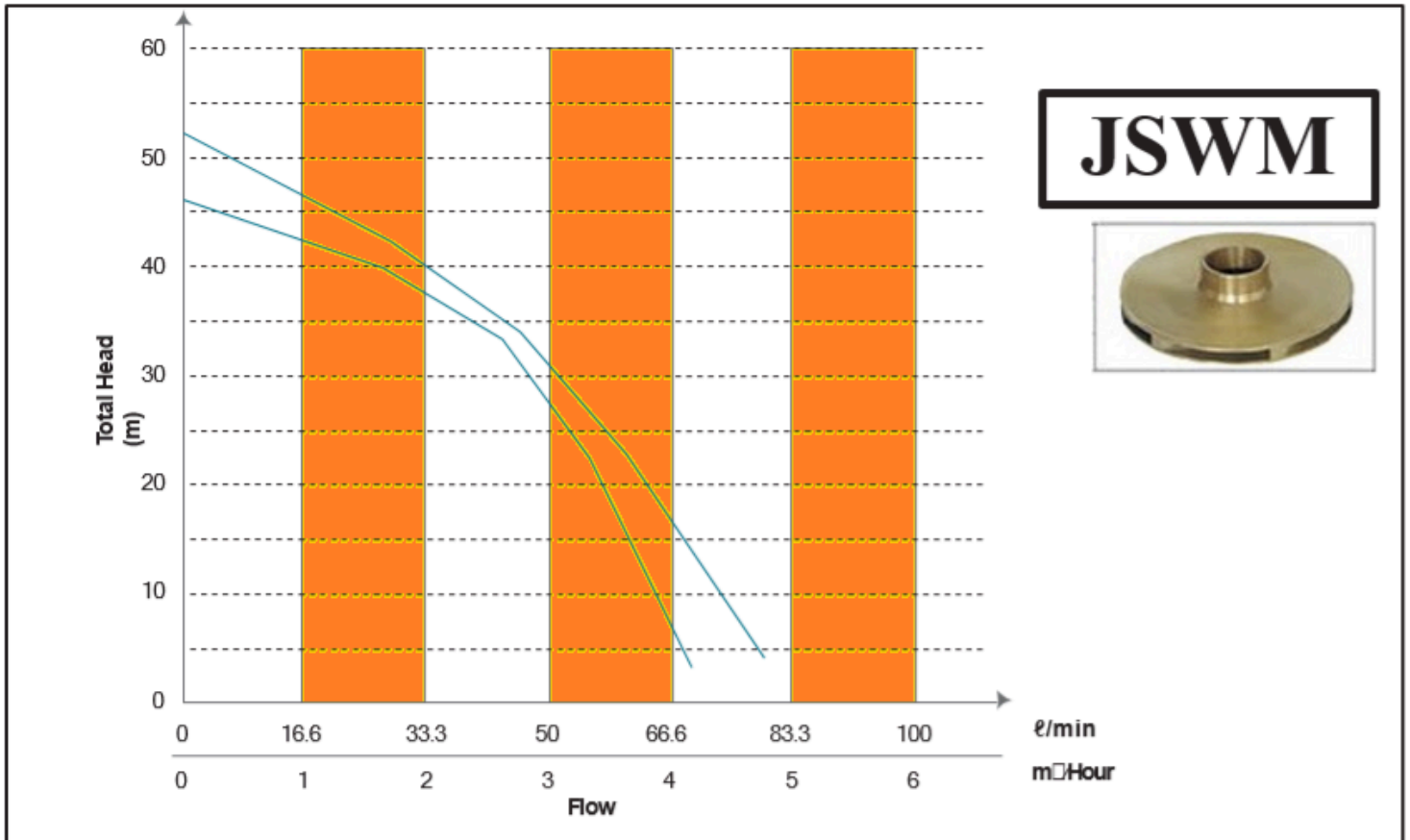

Technical Data

NO	MODE	POWER		Q (m³/h)	0	0.3	0.9	1.2	1.5	2.4	3	3.6	4.2	4.8
	Single-phase	kW	HP	Q (l/min)	0	5	15	20	25	40	50	60	70	80
1	JSWM75	0.75	1	± (E)	46	42.6	38	35	32.9	25	22.9	9	3.5	-
2	JSWM110	1.1	1.5		52	46.3	41.7	39.5	37.2	31.2	27.9	15	7	4

Dimensions

No	Model	Freq.	Suct. Max	Size	Start-up Amps	Running Amps	Dimension	N/W
	Single-phase	Hz	m	inch	A	A	L x W x H mm	kg
1	JSWM75	50	9	1" x 1"	16	5.2	455x185x210	16.5
2	JSWM110	50	9	1" x 1"	23	7.5	455x185x210	16.5



+27 62 375 5088



+27 65 321 5803



<https://www.thewatersolarcompany.co.za/>



<https://maps.app.goo.gl/MBR2LMW3T6f9TtHV9>



<https://www.facebook.com/watersolarcompany>



<https://www.youtube.com/@TheWaterSolarCompany/>



<https://www.instagram.com/watersolarcompany2023/>